



TECHNICAL SPECIFICATIONS			
<b>Model No.</b>	NE7-035	NE7-100	NE7-150
<b>Power Consumption (±5%)</b>	35W±5	100W±5	150W±8
<b>Power Supply</b>	SOSEN/MOSO/CZCL		
<b>Input Voltage</b>	AC 100-277VAC/50 / 60 Hz		
<b>Power Factor</b>	>0.92		
<b>Surge Protection</b>	SOSEN: 10kV lline-earth, 6kV line-line / MOSO: 10kV lline-earth, 5kV line-line CZCL: 6kV lline-earth, 4kV line-line		
<b>Driver Type</b>	Constant Current (CC) / Constant Voltage (CV)		
<b>Control</b>	0-10V dim/DMX control		
OPTIC SPECIFICATIONS			
<b>LED Type 1</b>	CREE-XPG3		
<b>Luminous Flux (±10%)</b>	3500 lm / 2450 lm (with honeycomb film)	10000 lm / 7000 lm (with honeycomb film)	15000 lm / 10500 lm (with honeycomb film)
<b>Efficacy (@4000K Ra80)</b>	100 lm/W / 70 lm/W (with honeycomb film)		
<b>Beam Angle</b>	F00111/F00113/F00114/F00115/F00116/F00117		
<b>LED Type 2</b>	CREE-XPE2		
<b>Luminous Flux (±10%)</b>	2450 lm	7000 lm	10500 lm
<b>Efficacy (@4000K Ra80)</b>	70 lm/W		
<b>Beam Angle</b>	F00110/F00118		
<b>Correlated Color Temperature</b>	4000K (2200K,3000K, 5000K optional)/RGB/RGBW/CCT adjustable (2200K-4000K)		
<b>Color Rendering Index</b>	Ra80 (Ra70, Ra90 optional)		
<b>UGR level</b>	N/A		

## DESCRIPTION

NE7 is designed for landscape lighting and offers a variety of beam angles. The lamp has four kinds of light-emitting modes: single white, CCT adjustable, RGB, and RGBW. Its four control functions, 0-10V dim, Dali dim, Bluetooth control, and DMX control, allow for versatility.

## FEATURES

- Modern look
- Different angles for flexibility
- Minimum angle 3.8°
- Color options: single white, CCT adjustable, RGB, RGBW
- Smart control: 0-10V, DALI, bluetooth, DMX control
- Excellent heat dissipation for longer lifespan

## APPLICATION

- Facades
- Plazas
- Parks
- Advertising boards
- Bridges

## MOUNTING AND PRODUCT DIMENSIONS

<b>Product Dimension</b>	8.64" × 12.99" × 3.94"	17.72" × 17.79" × 6.30"
<b>Luminaire Net Weight</b>	8.15±0.66 Lbs.	22.04±0.66 Lbs.
<b>Export Carton Size</b>	14.17" × 11.41" × 7.08"	20.66" × 19.48" × 9.25"
<b>Gross Weight</b>	9.92±0.66 Lbs.	25.35±0.66 Lbs.
<b>Mounting Option</b>	Base Mounting/Bracket Mounting/Embrace Hoop Mounting/Ground Spike Mounting	
<b>Material</b>	Aluminum Alloy PC+PMMA lens Glass	
<b>Finish</b>	Powder Coating	
<b>Fixture Color</b>	Silver	
<b>EPA</b>	0.35ft <sup>2</sup>	1.12ft <sup>2</sup>
<b>IK Rating</b>	IK08	
<b>IP Rating</b>	IP66	
LIFESPAN AND WARRANTY		
<b>Operating Temperature</b>	-22°F to 122°F	
<b>Life Time of LED @Ta=25°C</b>	48000 hrs - L80 77000 hrs - L70	
<b>Warranty</b>	5 Years	

## Safety Certifications

Luminaires (UL 1598:2021 Ed.5)

PHOTOMETRY

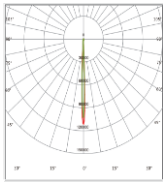

F00110

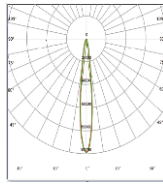

F00111

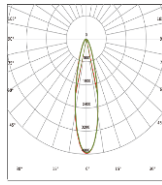

F00113

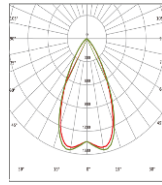

F00114

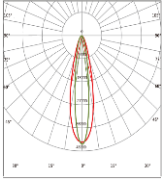

F00115

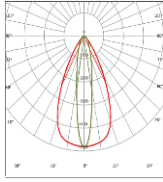

F00116

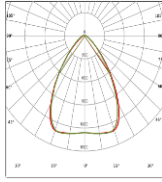

F00117

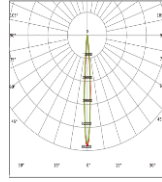

F00118

MOUNTING OPTIONS



Base mounting



Bracket mounting



Embrace hoop mounting



Ground spike mounting

DIMENSIONS

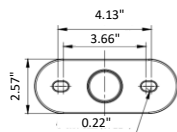
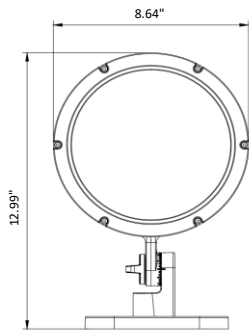

35

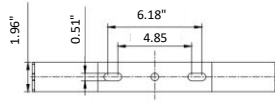
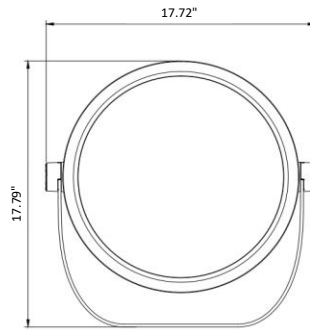
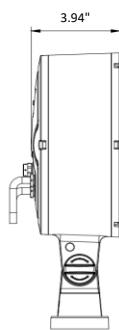

100/150

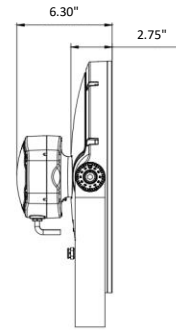

ACCESSORIES



**Safety rope**  
Stainless steel rope, 1m length.



**Shield (35W)**  
Prevents light pollution.



**Shield (150W)**  
Prevents light pollution.



**Ground spike**

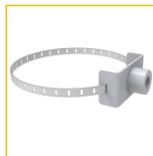

**Embrace hoop**  
For mounting on pipes.