



DESCRIPTION

NE7 is designed for landscape lighting, with a variety of beam angles. The lamp has four kinds of light emitting modes, single white, CCT adjustable, RGB and RGBW, as well as four control functions of 0-10V dim, Dali dim, bluetooth control and DMX control, which can ensure normal use in various occasions.

KEY FEATURES

- Exquisite appearance;
- Different angles for choice;
- Minimum angle 3.8°;
- Color options: single white, CCT adjustable, RGB, RGBW;
- Smart control: 0-10V, DALI, bluetooth, DMX control;
- Excellent heat dissipation, longer lifespan;

APPLICATION(S)

- Facades appearance
- Square
- Plaza
- Business street
- Park
- Advertising board
- Bridge

PHOTOMETRY

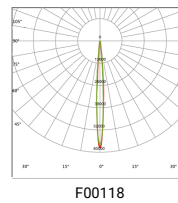
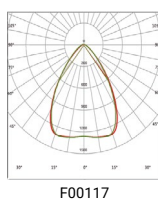
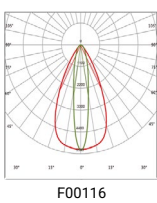
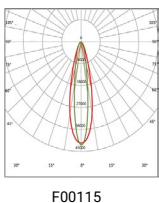
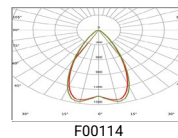
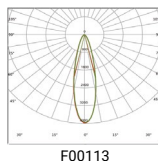
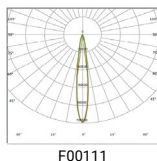
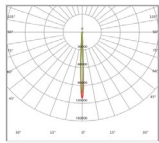

Catalog Number	
Notes	
Type	

TECHNICAL SPECIFICATIONS

Model No.	NE7-035	NE7-100	NE7-150
Power Consumption(±10%)	35W±5	100W±5	150W±8
Power Supply	SOSEN/MOSO/CZCL		
Input Voltage	AC 100-277VAC/50 / 60 Hz		
Power Factor	>0.92		
Surge Protection	SOSEN: 10kV line-earth, 6kV line-line / MOSO: 10kV line-earth, 5kV line-line		
	CZCL: 6kV line-earth, 4kV line-line		
Driver Type	Constant Current (CC)/Constant Voltage (CV)		
Control	0-10V dim/DMX control		

OPTIC SPECIFICATIONS

LED Type	CREE-XPG3		
Luminous Flux (±10%)	3500lm/2450lm	10000lm/7000lm	15000lm/10500lm
Efficacy(4000K Ra80)	100lm/W /70lm/W (with honeycomb film)		
Correlated Color Temperature	4000K (2200K,3000K, 5000K optional)/RGB/RGBW/CCT adjustable(2200K-4000K)		
Color Rendering Index	Ra80 (Ra70, Ra90 optional)		
Beam Angle	F00110 to F00118		

MOUNTING AND PRODUCT DIMENSIONS

Product Dimension	219.5x330x100mm (8.64"x12.99"x3.94")	450x452x160mm (17.72"x17.79"x6.30")
Luminaire Net Weight	3.7±0.3kg (8.15±0.66Lbs)	10±0.3kg (22.04±0.66Lbs)
Export Carton Size	360x290x180mm (14.17"x11.41"x7.08")	525x495x235mm (20.66"x19.48"x9.25")
Gross Weight	4.5±0.3kg (9.92±0.66Lbs)	11.5±0.3kg (25.35±0.66Lbs)
Mounting Option	Base Mounting/Bracket Mounting/Embrace hoop Mounting/Ground spike Mounting	
Material	Aluminum Alloy	
	PC+PMMA lens	
	Glass	
Finish	Powder Coating	
Fixture Color	Silver	
EPA	0.35ft ²	1.12ft ²
IK Rating	IK08	
IP Rating	IP66	

LIFESPAN AND WARRANTY

Operating Temperature	-30°C to + 50°C (-22°F to 122°F)
Life Time of LED @Ta=25°C	48000hrs-L80 77000hrs-L70
Warranty	5 Years

SAFETY CERTIFICATIONS

Luminaires (UL 1598:2021 Ed.5)
Luminaires (CSA C22.2#250.0:2021 Ed.5)

MOUNTING OPTIONS



Base mounting



Bracket mounting



Embrace hoop mounting



Ground spike mounting

DIMENSIONS

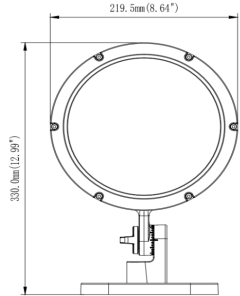

35W

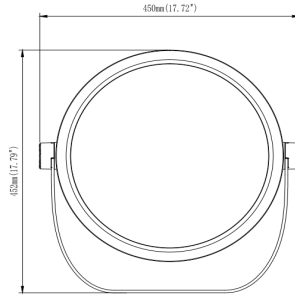
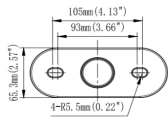
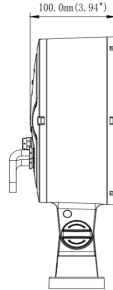

100/150W

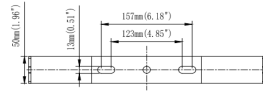
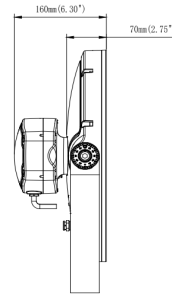

ACCESSORIES

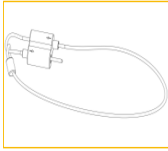

Safety rope

Stainless steel rope, 1m length.
Code: SL-F33-01(for 35W-150W)

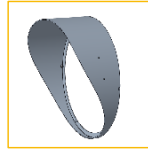

Visor

Prevention of light pollution.
Code: BC-F39-01(for 35W)



Visor

Prevention of light pollution.
Code: BC-F39-02(for 150W)



Ground spike

Code: MT-F39-01

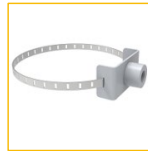

Embrace hoop

Suitable for pipeline installation.
Code: BC-F39-03(for 35W)

ORDERING INFORMATION

Series	Wattage & Lumen Output	Voltage	Corelated Color Temperature (CCT)	Beam Angle	Control Options
NE7 (NE7 LED Landscape Light)	35W (3500lm/2450lm)	MV (100-277V)	22K (2200K)	F00110	0-10V (Dimmable)
	100W (10000lm/7000lm)		30K (3000K)	F00111	
	150W (15000lm/10500lm)		40K (4000K)	F00112	
			50K (5000K)	F00113	
			F00114		
			F00115		
			F00116		
			F00117		
			F00118		
Mounting Options	Finish Color	Accessories			
BM (Base Mounting) BRM (Bracket Mounting) EH (Embrace Hoop Mounting) GSM (Ground Spike Mounting)	S (Silver)	SL-F33-01(Safety rope for 35W-150W) BC-F39-01 (Visor for 35W) BC-F39-02 (Visor for 150W) MT-F39-01 (Ground spike) BC-F39-03 (Embrace hoop for 35W)			